

From the library of: **CONSEW** Needle Cord
MODEL 220, & 220B

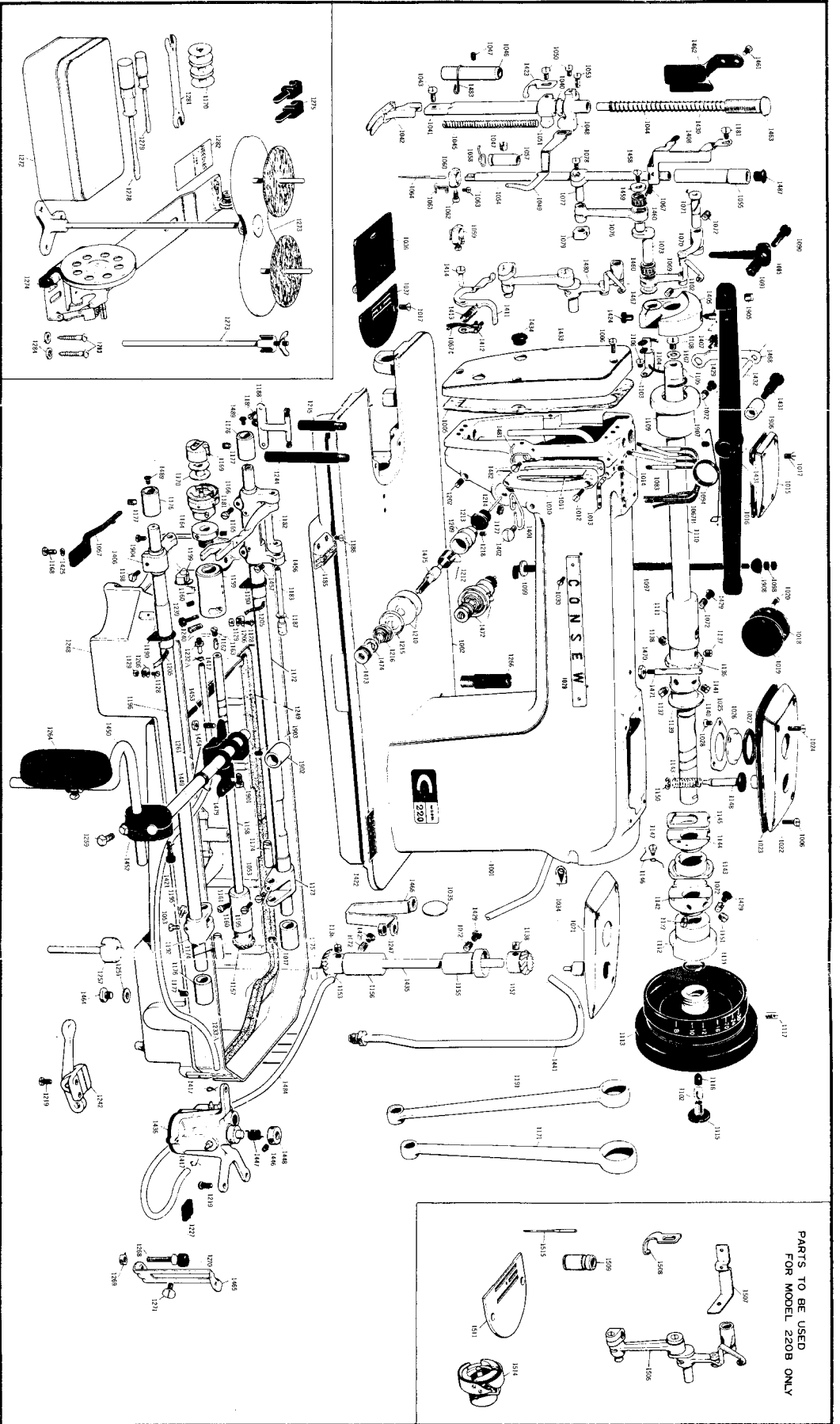

PARTS TO BE USED
FOR MODEL 220B ONLY

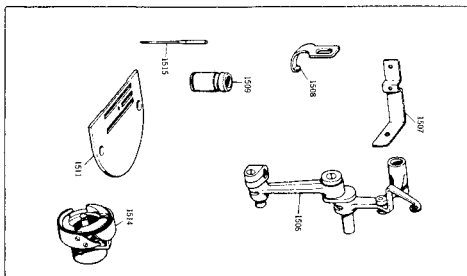

CONSEW MODEL 220, & 220B

From the library of: Diamond Needle Corp

PART NO	PART NAME	PART NO	PART NAME	PART NO	PART NAME	PART NO	PART NAME
1001	ARM ONLY	1097	KNEE LIFTER POLL ROD	1182	THRUST WASHER FOR 1183	1424	CLAMP SCREW FOR 1480
1002	BED ONLY	1098	NUT FOR 1097	1183	OIL SHOCK HOLDER	1425	SPRING WASHER FOR 1188
1005	GASKET FOR 1433	1099	FELT WASHER FOR 1097	1188	RUBBER FLANGE	1429	PLUG FOR SCREW HOLE
1006	SCREW FOR TAKE UP LEVER	1101	SET SCREW FOR 1405	1190	FEED LIFTING CRANK ROD	1430	PRESSURE REGULATOR BAR
1010	GASKET FOR TAKE UP LEVER	1102	RETAINER PLATE FOR 1104	1191	FEED LIFTING BELL CRANK	1431	KNEE LIFTER LEVER
1011	GASKET FOR TAKE UP LEVER	1103	RETAINER PLATE FOR 1104	1192	FEED LIFTING BELL CRANK	1432	KNEE LIFTER BAR
1012	SCREW FOR GUIDE	1104	OIL WICK FOR 1480	1195	SET SCREW FOR 1192 AND 1173	1433	FACE COVER PLATE
1013	THREAD GUIDE WITH THREE HOLES	1105	SPRING FOR 1104	1196	FEED LIFTING SHAFT	1434	FACE COVER PLATE
1014	SET SCREW FOR 1013	1106	SCREW FOR 1103	1198	CLAMP SCREW FOR 1406	1435	VERTICAL SHAFT ONLY
1016	SCREW FOR 1015	1107	SCREW FOR 1106	1199	SLIDING BLOCK COMPLETE FOR 1182	1440	OIL FEED TUBE COMPLETE
1017	BACK COVER PLATE	1108	TOP SHAFT FRONT BRUSHING	1200	OIL WICK FOR FEED SHAFT	1441	OIL FEED TUBE COMPLETE
1018	BACK COVER PLATE	1109	TOP SHAFT ONLY	1206	OIL WICK CONTROL BAND	1444	SPRING JOINT
1019	GASKET FOR 1018	1110	TOP SHAFT CENTER BRUSHING	1209	TENSION BARREL	1448	COLLAR FOR 1447
1020	SCREW FOR 1018	1111	TOP SHAFT REAR BRUSHING	1210	TENSION BARREL	1449	KNEE LIFTER SHAFT
1021	TOP COVER PLATE COMPLETE	1112	HAND WHEEL	1212	CHECK SPRING	1450	KNEE LIFTER ARM
1022	TOP COVER PLATE ONLY	1113	PACKING FOR 1113	1213	PACKING FOR 1472 PIN	1452	KNEE LIFTER ARM JOINT
1023	GASKET FOR 1022	1114	CAP SCREW FOR 1113	1214	TENSION RELEASE WASHER	1453	ADJUST SCREW FOR 1479
1024	GASKET FOR 1022	1115	TOP SHAFT OIL STOPPER	1215	TENSION SPRING	1454	NUT FOR 1453
1025	PSAME FOR 1022	1116	SCREW FOR 1115	1216	SCREW FOR 1475	1456	FEED BAR BELL CRANK
1026	OIL GAUGE WINDOW	1117	SCREW FOR 1206	1219	SCREW FOR 1475	1457	SET SCREW FOR 1459
1027	PACKING FOR 1026	1118	NUT FOR 1128	1219	MAGNET	1459	THRUST WASHER FOR 1460
1028	SCREW FOR 1025	1119	TOP SHAFT GEAR	1227	OIL HOSE NIPPLE	1460	BEARING ROLLERS COMPLETE
1029	NAME PLATE	1137	SET SCREW FOR CAM & GEAR	1232A	OIL HOSE	1461	SET SCREW FOR 1462
1030	SCREW FOR 1029	1138	SET SCREW FOR 1139	1233A	OIL HOSE	1462	OIL STOPPER
1034	STITCH LENGTH INDICATOR	1139	FEED CAM RATCHET	1239	OIL REGULATING VALVE	1463	PRESSURE REGULATOR SCREW
1035	PLUG FOR BED HOLE	1140	FEED RASING CAM	1240	SPRING FOR 1239	1464	DRAIN PLUG
1036	SLIDE PLATE COMPLETE	1141	FEED CAM SLIDE BLOCK	1242	KNEE LIFTER RELEASE LEVER COMPLETE	1465	OIL PAN SUPPORT
1037	NEEDLE PLATE	1142	FEED CAM GUIDE	1244	BED LEG FRONT COMPLETE	1466	BED LEG RIGHT
1038	NEEDLE WASHER FOR 1041	1143	FEED CAM SLIDE BLOCK	1245	THRUST WASHER FOR 1480	1467	KNEE LIFTER PLATE
1040	PRESSER BAR ONLY	1144	STOP PIN FOR 1139	1247	NUT FOR 1466	1468	KNEE LIFTER PLATE
1042	HINGED FOOT COMPLETE	1145	SPRING FOR 1145	1248	OIL PAN ONLY	1470	STOOL PIN
1043	SCREW FOR 1042	1146	SPRING FOR 1146	1249	OIL PAN GASKET	1471	TENSION COMPLETE
1044	PRESSER SPRING OUTER	1147	PUSH BUTTON	1251	PACKING FOR 1464	1472	TENSION ADJUSTING KNOB
1045	PRESSER SPRING INNER	1148	SPRING FOR 1148	1251	KNEE LIFTER PLUNGER	1473	TENSION STUD
1046	BUSHING FOR 1041	1149	RETAINING RING FOR 1149	1255	SET SCREW FOR KNEE LIFTER	1474	RATCHET FOR 1473
1047	SET SCREW FOR 1046 & 1057	1150	SET SCREW FOR 1149	1259	SPRING FOR 1479	1475	TENSION STUD
1048	PRESSER BAR GUIDE BRACKET	1151	VERTICAL SHAFT UPPER GEAR	1261	KNEE LIFTER PAD COMPLETE	1479	KNEE LIFTER CONTROLLER
1049	SCREW FOR 1423	1152	VERTICAL SHAFT LOWER GEAR	1266	OIL DRIVE SCREW FOR 1087	1480	NEEDLE GUIDE LEFT
1050	PRESSER BAR LIFTER	1153	VERTICAL SHAFT UPPER BRUSHING	1268	NUT FOR 1268	1481	SET SCREW FOR 1481
1051	PRESSER BAR LIFTER	1155	VERTICAL SHAFT LOWER BRUSHING	1269	SCREW DRIVER LARGE	1482	LOWER CLAMP FOR 1484
1053	SET SCREW FOR 1048	1156	HOOK SHAFT ONLY	1270	OIL PAN CUSHION RUBBER	1483	OIL RETURN TUBE
1054	NEEDLE BAR ONLY	1157	HOOK SHAFT ONLY	1271	SCREW FOR 1465	1487	RUBBER CAP FOR 1055
1055	NEEDLE BAR UPPER BRUSHING	1158	HOOK SHAFT FRONT BRUSHING	1272	ACCESSORY BOX	1489	RUBBER CAP FOR 1172 & 1196
1057	NEEDLE BAR LOWER BRUSHING	1159	HOOK SHAFT FRONT BRUSHING	1273	BOBBIN WINDER ASSEMBLY	1491	SET SCREW FOR 479
1058	THREAD GUIDE FOR 1057	1160	HOOK SHAFT REAR BRUSHING	1274	BEAD HINGE COMPLETE	1492	BUSHING FOR 148
1059	NEEDLE CLAMP COMPLETE	1161	SET SCREW FOR 1158 & 1161	1275	SCREW DRIVER LARGE	1493	SET SCREW FOR 902
1060	NEEDLE CLAMP BODY	1162	SET SCREW FOR 1162	1276	SCREW DRIVER SMALL	1493	SET SCREW FOR 191
1061	SCREW FOR 1060	1163	OIL DEFLECTOR FOR 1169	1281	WRENCH SMALL	1495	SET SCREW FOR 322
1062	SCREW FOR 1061	1165	ROTATING HOOK ASSEMBLY	1282	NEEDLES	1496	BUSHING FOR 1431
1063	SCREW FOR 1061	1166	HOOK RETAINER	1283	WOOD SCREW FOR 1274	1497	SET SCREW FOR 386
1064	NEEDLE	1167	BOBBIN CASE ASSEMBLY	1284	WASHER FOR 1283	1498	STOPPER FOR 1087
1067A	E OIL WICK	1168	BOBBIN	1401	THREAD GUIDE, RIGHT	PART TO BE USED MODEL 220B ONLY	
1069	TAKE UP LEVER BODY	1169	FEED ROCK CONNECTOR ROD	1402	SET SCREW FOR 1401	1386	TAKE UP LEVER COMPLETE
1070	TAKE UP LEVER LINK	1170	FEED ROCK SHAFT	1406	FEED LIFTER BELL CRANK	1397	RETAINER PLATE FOR OIL WICK
1071	HINGED STUD FOR 1070	1171	FEED ROCK SHAFT	1406	OIL WICK RETAINER	1398	RETAINING PLATE FOR TENSION RELEASE
1072	SET SCREW FOR 1071	1172	HINGED PIN FOR 1173	1411	THREAD TENSION RELEASE	1509	NEEDLE BAR LOWER BRUSHING
1076	NEEDLE BAR BRACKET	1173	REAR BUSHING FOR 1172	1412	OIL WICK RETAINER	1511	NEEDLE PLATE
1077	CLAMP SCREW FOR 1077	1175	FRONT BUSHING FOR 1172	1413	SPRING FOR 1411	1514	ROTATING HOOK ASSEMBLY
1079	SLIDING BLOCK FOR 1077	1177	CLAMP SCREW FOR 1452	1414	CLAMP SCREW FOR 1452	1515	NEEDLE
1083	GUIDE TUBE FOR 1067B	1181	FEED BAR SHAFT	1421	NEEDLE SIZE PLATE FOR TENSION RELEASE		
1085	PRESSER BAR LIFTER LEVER	1182	FEED BAR SHAFT				
1090	HINGE SCREW FOR 1085	1183	FEED BAR SHAFT				
1091	LOCK NUT FOR 1085	1185	FEED BDC				
1094	HINGED SCREW FOR 1431	1186	SCREW FOR 1185				

From the library of: **Diamond Needle Corp**
CONSEW MODEL 210, 210A & 210B

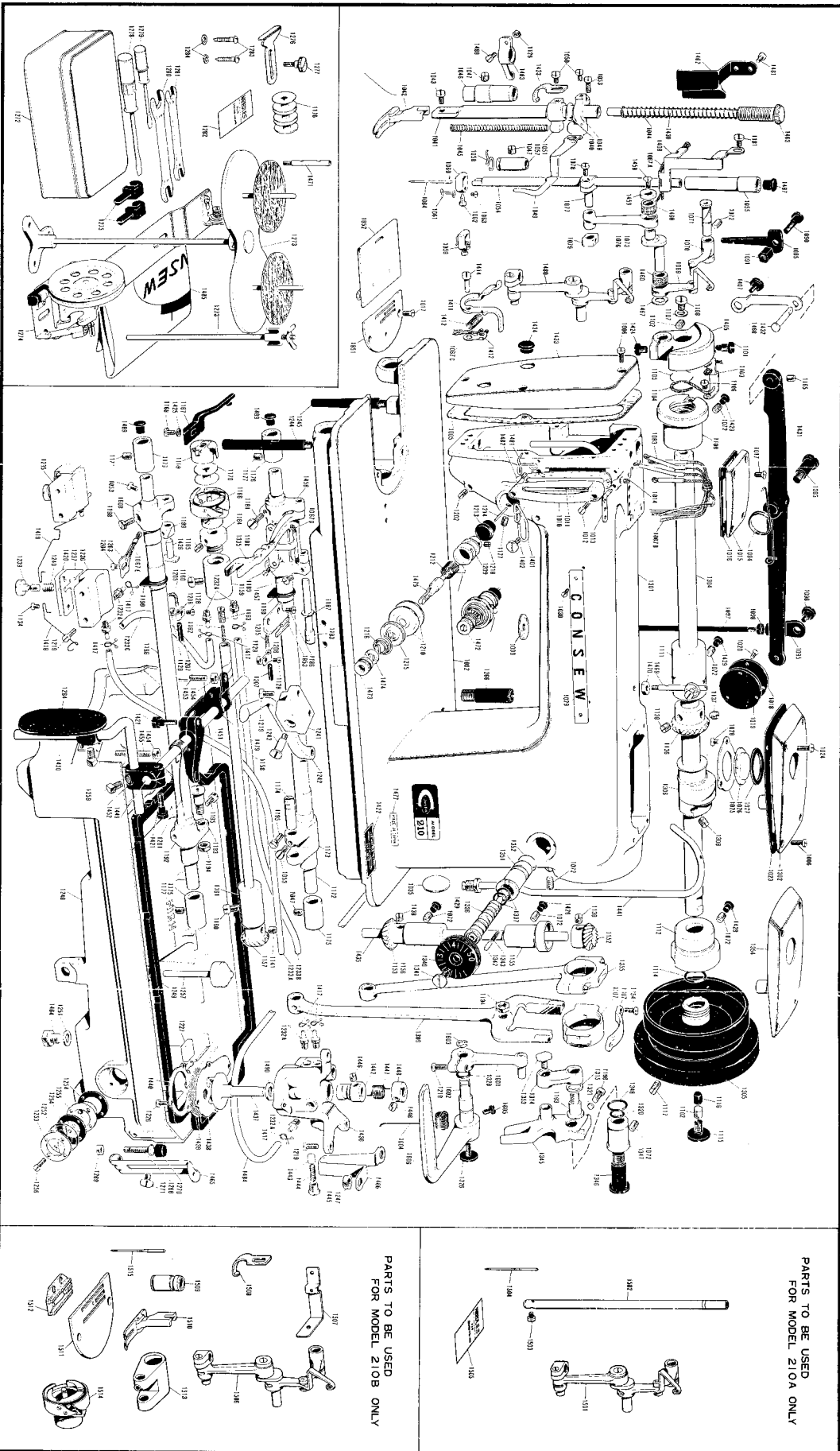

PARTS TO BE USED FOR MODEL 210A ONLY

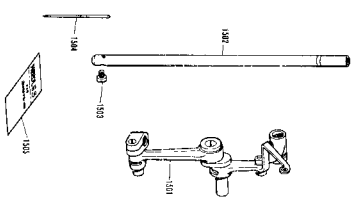

PARTS TO BE USED FOR MODEL 210B ONLY

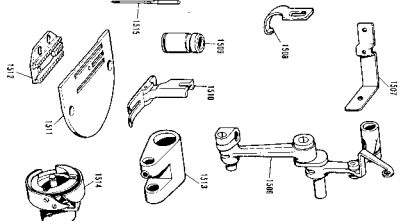

CONSEW MODEL 210, 210A & 210B

PART NO	PART NAME	PART NO	PART NAME	PART NO	PART NAME	PART NO	PART NAME
1002	BED ONLY	1102	SET SCREW FOR 1480	1213	PACKING FOR 1472	1316	FEED REGULATOR DIAI. SHAFT
1005	GASKET FOR 1433	1103	RETAINER PLATE FOR 1104	1214	TENSION RELEASE PIN	1317	OIL SEAL FOR 1316
1006	SCREW FOR 1433	1104	OIL WICK FOR 1480	1215	TENSION RELEASE WASHER	1318	FEED REGULATOR DIAI.
1010	GUARD FOR TAKE UP LEVER	1105	SPRING FOR 1104	1216	TENSION SPRING	1319	LOCK SCREW FOR 1340
1012	GASKET FOR 1010	1106	SCREW FOR 1103	1218	SET SCREW FOR 1475	1341	STOP PIN FOR 1340
1013	THREAD GUIDE WITH THREE HOLES	1107	TOP SHAFT FRONT PACKING	1219	SCREW FOR OIL PUMP	1342	SPRING FOR 1342
1014	SET SCREW FOR 1013	1108	TOP SHAFT FRONT BUSHING	1220	MANNET	1343	FEED REGULATOR FORK
1015	COVER PLATE FOR OIL WELL	1110	TOP SHAFT CENTER BUSHING	1221	SHIM FOR 1343	1344	BRUSHING FOR 1345
1016	GASKET FOR 1015	1111	TOP SHAFT REAR BUSHING	1222	OIL HOSE A	1345	FEED REGULATOR FORK
1017	SCREW FOR 1015	1112	PACKING FOR 1305	1223A	OIL HOSE B	1346	BRUSHING FOR 1345
1018	HACK COVER PLATE	1114	CAP SCREW FOR 1305	1223B	OIL HOSE C	1348	OIL SEAL FOR 1347
1019	GASKET FOR 1018	1115	TOP SHAFT OIL STOPPER	1233C	OIL HOSE C	1351	FEED REGULATOR DIAI. BUSHING
1020	SCREW FOR 1018	1116	SET SCREW FOR 1305	1233C	OIL HOSE C	1352	OIL SEAL FOR 1351
1021	SCREW FOR 1022	1117	SCREW FOR 1305	1236	OIL REGULATOR BODY	1353	CAP SCREW FOR 1314
1022	FRAME FOR 1026	1118	SCREW FOR 1206	1237	OIL REGULATOR VALVE	1354	CRANK ROD COMPLETE
1025	OIL CALICE WINDOW	1119	TOP SHAFT GEAR	1238	SHIM FOR 1239	1355	THREAD GUIDE. RIGHT
1026	PACKING FOR 1025	1120	TOP SHAFT GEAR	1241	BRACKET FOR 1242	1401	THREAD GUIDE. LEFT
1027	SCREW FOR 1025	1121	SET SCREW FOR CAN & GEAR	1242	HINGE SCREW FOR 1242	1402	SCREW FOR 1401
1028	NAME PLATE	1122	SET SCREW FOR 1157	1243	HINGE SCREW FOR 1242	1407	HINGE SCREW FOR 1401
1029	PIG FOR RED HOLE	1123	VERTICAL SHAFT UPPER GEAR	1244	BED LEG REAR	1408	OIL WICK RETAINER
1030	THRUSTR WASHER FOR 1041	1124	VERTICAL SHAFT LOWER GEAR	1245	NUT FOR 1466	1411	THREAD TENSION RELEASE
1031	PRESSER BAR ONLY	1125	VERTICAL SHAFT LOWER BUSHING	1246	OIL PAN ONLY	1412	OIL WICK RETAINER
1032	PRESSER BAR COMPLETE	1126	HOOK SHAFT GEAR	1247	OIL PAN GASKET	1413	SPRING FOR 1411
1033	SCREW FOR 1032	1127	HOOK SHAFT GEAR	1248	MARKER	1414	SHAFT FOR 1411
1034	PRESSER SPRING. OUTER	1128	HOOK SHAFT FRONT BUSHING	1249	MARKER WINDOW	1418	OIL HOSE SUPPOTER A
1035	BUSHING FOR 1041	1129	HOOK SHAFT FRONT BUSHING	1250	PACKING FOR 1252	1419	OIL HOSE SUPPOTER B
1036	BUSHING FOR 1041	1130	HOOK SHAFT REAR BUSHING	1251	SCREW FOR 1252	1420	OIL REGULATOR PLATE
1037	SET SCREW FOR 1041	1131	FEEL FOR 1158	1252	SCREW FOR 1253	1421	CLAMP SCREW FOR 1451 & 1452
1038	THREAD GUIDE FOR 1046 & 1057	1132	SET SCREW FOR 1162	1253	SCREW FOR 1253	1422	NEEDLE SIZE PLATE
1039	THREAD GUIDE FOR 1042	1133	SET SCREW FOR 1159	1254	KNEE LIFTER PLUNGER	1423	ADJUST PLATE FOR TENSION RELEASE
1040	THREAD GUIDE FOR 1042	1134	SET SCREW FOR 1164	1255	SPRING FOR 1481	1424	CLAMP SCREW FOR 1480
1041	THREAD GUIDE FOR 1042	1135	FEEL HOOK SHAFT	1256	KNEE LIFTER PAD	1425	STUD FOR 1159
1042	NEEDLE BAR UPPER BUSHING	1136	ROTATING HOOK ASSEMBLY	1257	KNEE LIFTER PAD	1426	STUD FOR 1159
1043	NEEDLE BAR ONLY	1137	ROTATING HOOK ASSEMBLY	1258	OIL PAN HOLDING SCREW	1427	SCREW FOR 1159
1044	NEEDLE BAR ONLY	1138	ROBBIN CASE ASSEMBLY	1259	OIL PAN HOLDING SCREW	1430	PRESSURE REGULATOR BAR
1045	NEEDLE BAR UPPER BUSHING	1139	FEEL HOOK ARM	1270	NUT FOR 1268	1431	KNEE LIFTER BAR
1046	NEEDLE BAR LOWER BUSHING	1140	FEEL HOOK ARM	1271	OIL PAN CUSHION RUBBER	1432	KNEE LIFTER BAR
1047	NEEDLE BAR LOWER BUSHING	1141	HINGED PIN FOR 1173	1272	SCREW FOR 1485	1433	FACE COVER PLATE
1048	NEEDLE CLAMP COMPLETE	1142	REAR BUSHING FOR 1172	1273	ACCESSORY BOX	1434	VERTICAL SHAFT ONLY
1049	NEEDLE CLAMP COMPLETE	1143	REAR BUSHING FOR 1172	1274	BOBBIN WINDER ASSEMBLY	1435	PLUG FOR 1433
1050	NEEDLE CLAMP COMPLETE	1144	CLAMP SCREW FOR 1456	1275	BOBBIN WINDER ASSEMBLY	1436	OIL PUMP BODY
1051	NEEDLE CLAMP COMPLETE	1145	FEEL BAR SHAFT	1276	BOBBIN WINDER ASSEMBLY	1437	OIL PUMP TAPLER
1052	NEEDLE CLAMP COMPLETE	1146	FEEL BAR SHAFT	1277	BOBBIN WINDER ASSEMBLY	1438	OIL PUMP TAPLER
1053	NEEDLE CLAMP COMPLETE	1147	FEEL BAR SHAFT	1278	BOBBIN WINDER ASSEMBLY	1439	OIL PUMP TAPLER
1054	NEEDLE CLAMP COMPLETE	1148	FEEL BAR SHAFT	1279	BOBBIN WINDER ASSEMBLY	1440	FRAME FOR 1439
1055	NEEDLE CLAMP COMPLETE	1149	FEEL BAR SHAFT	1280	BOBBIN WINDER ASSEMBLY	1441	FRAME FOR 1439
1056	NEEDLE CLAMP COMPLETE	1150	FEEL BAR SHAFT	1281	BOBBIN WINDER ASSEMBLY	1442	FRAME FOR 1439
1057	NEEDLE CLAMP COMPLETE	1151	FEEL BAR SHAFT	1282	BOBBIN WINDER ASSEMBLY	1443	FRAME FOR 1439
1058	NEEDLE CLAMP COMPLETE	1152	FEEL BAR SHAFT	1283	BOBBIN WINDER ASSEMBLY	1444	FRAME FOR 1439
1059	NEEDLE CLAMP COMPLETE	1153	FEEL BAR SHAFT	1284	BOBBIN WINDER ASSEMBLY	1445	FRAME FOR 1439
1060	NEEDLE CLAMP COMPLETE	1154	FEEL BAR SHAFT	1285	BOBBIN WINDER ASSEMBLY	1446	FRAME FOR 1439
1061	NEEDLE CLAMP COMPLETE	1155	FEEL BAR SHAFT	1286	BOBBIN WINDER ASSEMBLY	1447	FRAME FOR 1439
1062	NEEDLE CLAMP COMPLETE	1156	FEEL BAR SHAFT	1287	BOBBIN WINDER ASSEMBLY	1448	FRAME FOR 1439
1063	NEEDLE CLAMP COMPLETE	1157	FEEL BAR SHAFT	1288	BOBBIN WINDER ASSEMBLY	1449	FRAME FOR 1439
1064	NEEDLE CLAMP COMPLETE	1158	FEEL BAR SHAFT	1289	BOBBIN WINDER ASSEMBLY	1450	FRAME FOR 1439
1065	NEEDLE CLAMP COMPLETE	1159	FEEL BAR SHAFT	1290	BOBBIN WINDER ASSEMBLY	1451	FRAME FOR 1439
1066	NEEDLE CLAMP COMPLETE	1160	FEEL BAR SHAFT	1291	BOBBIN WINDER ASSEMBLY	1452	FRAME FOR 1439
1067	NEEDLE CLAMP COMPLETE	1161	FEEL BAR SHAFT	1292	BOBBIN WINDER ASSEMBLY	1453	FRAME FOR 1439
1068	NEEDLE CLAMP COMPLETE	1162	FEEL BAR SHAFT	1293	BOBBIN WINDER ASSEMBLY	1454	FRAME FOR 1439
1069	NEEDLE CLAMP COMPLETE	1163	FEEL BAR SHAFT	1294	BOBBIN WINDER ASSEMBLY	1455	FRAME FOR 1439
1070	NEEDLE CLAMP COMPLETE	1164	FEEL BAR SHAFT	1295	BOBBIN WINDER ASSEMBLY	1456	FRAME FOR 1439
1071	NEEDLE CLAMP COMPLETE	1165	FEEL BAR SHAFT	1296	BOBBIN WINDER ASSEMBLY	1457	FRAME FOR 1439
1072	NEEDLE CLAMP COMPLETE	1166	FEEL BAR SHAFT	1297	BOBBIN WINDER ASSEMBLY	1458	FRAME FOR 1439
1073	NEEDLE CLAMP COMPLETE	1167	FEEL BAR SHAFT	1298	BOBBIN WINDER ASSEMBLY	1459	FRAME FOR 1439
1074	NEEDLE CLAMP COMPLETE	1168	FEEL BAR SHAFT	1299	BOBBIN WINDER ASSEMBLY	1460	FRAME FOR 1439
1075	NEEDLE CLAMP COMPLETE	1169	FEEL BAR SHAFT	1300	BOBBIN WINDER ASSEMBLY	1461	FRAME FOR 1439
1076	NEEDLE CLAMP COMPLETE	1170	FEEL BAR SHAFT	1301	BOBBIN WINDER ASSEMBLY	1462	FRAME FOR 1439
1077	NEEDLE CLAMP COMPLETE	1171	FEEL BAR SHAFT	1302	BOBBIN WINDER ASSEMBLY	1463	FRAME FOR 1439
1078	NEEDLE CLAMP COMPLETE	1172	FEEL BAR SHAFT	1303	BOBBIN WINDER ASSEMBLY	1464	FRAME FOR 1439
1079	NEEDLE CLAMP COMPLETE	1173	FEEL BAR SHAFT	1304	BOBBIN WINDER ASSEMBLY	1465	FRAME FOR 1439
1080	NEEDLE CLAMP COMPLETE	1174	FEEL BAR SHAFT	1305	BOBBIN WINDER ASSEMBLY	1466	FRAME FOR 1439
1081	NEEDLE CLAMP COMPLETE	1175	FEEL BAR SHAFT	1306	BOBBIN WINDER ASSEMBLY	1467	FRAME FOR 1439
1082	NEEDLE CLAMP COMPLETE	1176	FEEL BAR SHAFT	1307	BOBBIN WINDER ASSEMBLY	1468	FRAME FOR 1439
1083	NEEDLE CLAMP COMPLETE	1177	FEEL BAR SHAFT	1308	BOBBIN WINDER ASSEMBLY	1469	FRAME FOR 1439
1084	NEEDLE CLAMP COMPLETE	1178	FEEL BAR SHAFT	1309	BOBBIN WINDER ASSEMBLY	1470	FRAME FOR 1439
1085	NEEDLE CLAMP COMPLETE	1179	FEEL BAR SHAFT	1310	BOBBIN WINDER ASSEMBLY	1471	FRAME FOR 1439
1086	NEEDLE CLAMP COMPLETE	1180	FEEL BAR SHAFT	1311	BOBBIN WINDER ASSEMBLY	1472	FRAME FOR 1439
1087	NEEDLE CLAMP COMPLETE	1181	FEEL BAR SHAFT	1312	BOBBIN WINDER ASSEMBLY	1473	FRAME FOR 1439
1088	NEEDLE CLAMP COMPLETE	1182	FEEL BAR SHAFT	1313	BOBBIN WINDER ASSEMBLY	1474	FRAME FOR 1439
1089	NEEDLE CLAMP COMPLETE	1183	FEEL BAR SHAFT	1314	BOBBIN WINDER ASSEMBLY	1475	FRAME FOR 1439
1090	NEEDLE CLAMP COMPLETE	1184	FEEL BAR SHAFT	1315	BOBBIN WINDER ASSEMBLY	1476	FRAME FOR 1439
1091	NEEDLE CLAMP COMPLETE	1185	FEEL BAR SHAFT	1316	BOBBIN WINDER ASSEMBLY	1477	FRAME FOR 1439
1092	NEEDLE CLAMP COMPLETE	1186	FEEL BAR SHAFT	1317	BOBBIN WINDER ASSEMBLY	1478	FRAME FOR 1439
1093	NEEDLE CLAMP COMPLETE	1187	FEEL BAR SHAFT	1318	BOBBIN WINDER ASSEMBLY	1479	FRAME FOR 1439
1094	NEEDLE CLAMP COMPLETE	1188	FEEL BAR SHAFT	1319	BOBBIN WINDER ASSEMBLY	1480	FRAME FOR 1439
1095	NEEDLE CLAMP COMPLETE	1189	FEEL BAR SHAFT	1320	BOBBIN WINDER ASSEMBLY	1481	FRAME FOR 1439
1096	NEEDLE CLAMP COMPLETE	1190	FEEL BAR SHAFT	1321	BOBBIN WINDER ASSEMBLY	1482	FRAME FOR 1439
1097	NEEDLE CLAMP COMPLETE	1191	FEEL BAR SHAFT	1322	BOBBIN WINDER ASSEMBLY	1483	FRAME FOR 1439
1098	NEEDLE CLAMP COMPLETE	1192	FEEL BAR SHAFT	1323	BOBBIN WINDER ASSEMBLY	1484	FRAME FOR 1439
1099	NEEDLE CLAMP COMPLETE	1193	FEEL BAR SHAFT	1324	BOBBIN WINDER ASSEMBLY	1485	FRAME FOR 1439
1100	NEEDLE CLAMP COMPLETE	1194	FEEL BAR SHAFT	1325	BOBBIN WINDER ASSEMBLY	1486	FRAME FOR 1439
1101	NEEDLE CLAMP COMPLETE	1195	FEEL BAR SHAFT	1326	BOBBIN WINDER ASSEMBLY	1487	FRAME FOR 1439